

## Crosby® Grade 100 Chain Fittings

**Fatigue Rated**

**"QT"**  
QUENCHED & TEMPERED

**Crosby 8/10™**

**S-1325**



- Designed to connect Grade 100 chain fittings produced with "Engineered Flat" to Grade 100 chain.
- Forged Alloy Steel - Quenched and Tempered.
- Suitable for use with Grade 100 and Grade 80 chain.
- Individually Proof Tested to 2-1/2 times the Working Load Limit with certification.
- Locking system that provides for simple assembly and disassembly - no special tools required.
- Fatigue rated at 1-1/2 times the Working Load Limit at 20,000 cycles.
- "Look for the Platinum Color - Crosby Grade 100 Alloy Products."

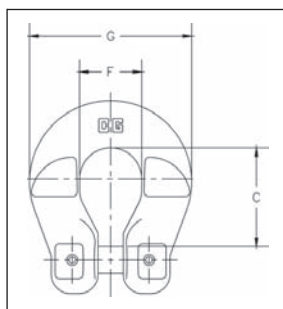

### S-1325 Grade 100 Chain Coupler

Chain Size		S-1325 Stock No.	Working Load Limit (lbs.)*	Weight Each (lbs.)	Dimensions (in.)		
(in.)	(mm)				C	F	G
-	6	1098496	3200	.25	1.03	.74	1.74
1/4	7	1098500	4300	.50	1.41	.88	2.32
5/16	8	1098504	5700	.50	1.40	.88	2.32
3/8	10	1098508	8800	.80	1.84	1.18	2.72
1/2	13	1098512	15000	1.70	2.12	1.50	3.62
5/8	16	1098516	22600	1.90	2.84	1.96	4.40

\* Minimum Ultimate Load is 4 times the Working Load Limit.

**Fatigue Rated**

**"QT"**  
QUENCHED & TEMPERED

**Crosby 8/10™**

**S-1311**



- Forged Alloy Steel - Quenched and Tempered.
- Individually Proof Tested to 2-1/2 times the Working Load Limit with certification.
- Suitable for use with Grade 100 and Grade 80 chain.
- Provided with spring designed to retain chain.
- The use of S-1311 Chain Shortener will allow 100 percent of the chain sling capacity.
- Fatigue rated at 1-1/2 times the Working Load Limit at 20,000 cycles.
- "Look for the Platinum Color - Crosby Grade 100 Alloy Products."

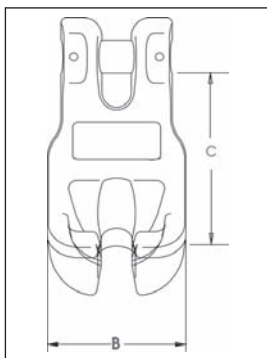

### S-1311 Grade 100 Chain Shortener Link

Chain Size		S-1311 Stock No.	Working Load Limit (lbs.)*	Weight Each (lbs.)	Dimensions (in.)	
(in.)	(mm)				B	C
-	6	1017797	3200	.75	1.46	1.72
1/4	7	1017806	4300	1.00	1.93	2.67
5/16	8	1017815	5700	1.00	1.93	2.66
3/8	10	1017824	8800	1.50	2.27	3.04
1/2	13	1017833	15000	3.25	2.99	3.92
5/8	16	1017842	22600	5.60	3.33	4.71

\* Minimum Ultimate Load is 4 times the Working Load Limit.

Copyright © 2008 The Crosby Group, Inc.  
All Rights Reserved