

G-4263

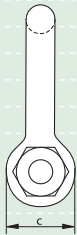
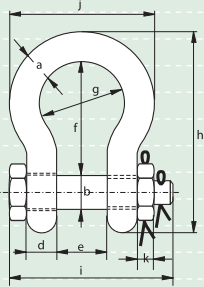

Green Pin® Wide Mouth Towing Shackles bow shackles with safety bolt

- **Material** : bow and pin alloy steel, Grade 8, quenched and tempered
- **Safety Factor** : MBL equals 4 x WLL
- **Finish** : hot dipped galvanized
- **Certificates** : at no extra charges this product can be supplied with a works certificate and/or certificate of basic raw material
- **Note** : for applications where a wider opening is required, for example towing systems on sea and harbour tugs

working load limit	diameter bow	diameter pin	diameter eye	width eye	width inside	length inside	width bow	length bow	length bolt	width	thickness nut	weight each
tons	a	b	c	d	e	f	g	h	i	j	k	kg
22	38	42	89	38	106	216	159	319	248	235	19	12.5
30	45	50	104	45	127	248	175	370	296	265	24	18
40	50	57	119	50	146	273	207	411	338	307	27	25
55	65	70	145	65	165	314	213	487	389	343	33	48
100	75	83	163	75	184	330	254	530	432	404	40	70

In inch

working load limit	diameter bow	diameter pin	diameter eye	width eye	width inside	length inside	width bow	length bow	length bolt	width	thickness nut	weight each
tons	a	b	c	d	e	f	g	h	i	j	k	lbs
22	1 1/2	1 5/8	3 1/2	1 17/32	4 3/16	8 1/2	6 9/32	12 9/16	9 3/4	9 1/4	3/4	27.56
30	1 3/4	2	4 1/8	1 25/32	5	9 3/4	6 7/8	14 9/16	11 11/16	10 7/16	15/16	39.68
40	2	2 1/4	4 11/16	1 31/32	5 3/4	10 3/4	8 5/8	16 3/16	13 5/16	12 1/8	1 3/32	55.12
55	2 1/2	2 3/4	5 3/4	2 9/16	6 1/2	12 3/8	8 3/8	19 3/16	15 5/16	13 1/2	1 5/16	105.82
100	3	3 1/4	6 7/16	2 15/16	7 1/4	13	10	20 7/8	17	15 7/8	1 19/32	154.32