

TURNBUCKLE END DIMENSIONS

CAUTION: NEVER EXCEED THE WORKING LOAD LIMIT

Ratings are stated in short tons (2,000 lbs) or pounds. All dimensions are in inches and pounds unless otherwise indicated
 Approximate dimensions shown. Contact us for specific dimensions, as they may differ between manufacturers

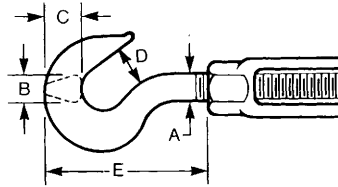

Hook dimensions

Dimensions in Inches				
A	B	C	D	E
1/4	.25	.41	.45	1.66
5/16	.31	.44	.50	1.91
3/8	.38	.53	.56	2.28
1/2	.50	.69	.66	2.84
5/8	.63	.84	.84	3.53
3/4	.75	1.00	.97	4.31
7/8	.88	1.19	1.13	5.00
1	1.00	1.38	1.25	5.69
1-1/4	1.06	1.50	1.50	6.91
1-1/2	1.31	1.75	1.88	8.69

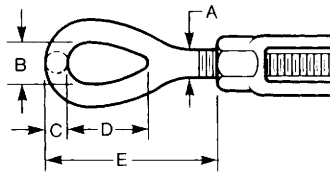

Eye dimensions

Dimensions in Inches				
A	B	C	D	E
1/4	.34	.22	.78	1.78
5/16	.44	.28	.94	2.19
3/8	.53	.34	1.13	2.56
1/2	.72	.44	1.44	3.22
5/8	.88	.50	1.75	3.88
3/4	1.00	.63	2.13	4.69
7/8	1.25	.75	2.38	5.25
1	1.44	.88	3.00	6.38
1-1/4	1.81	1.13	3.56	7.75
1-1/2	2.13	1.25	4.13	8.63
1-3/4	2.38	1.50	4.69	10.00
2	2.69	1.75	5.75	12.13
2-1/2	3.13	2.00	6.50	13.56
2-3/4	3.25	2.25	7.00	15.00